

HRH1532RE

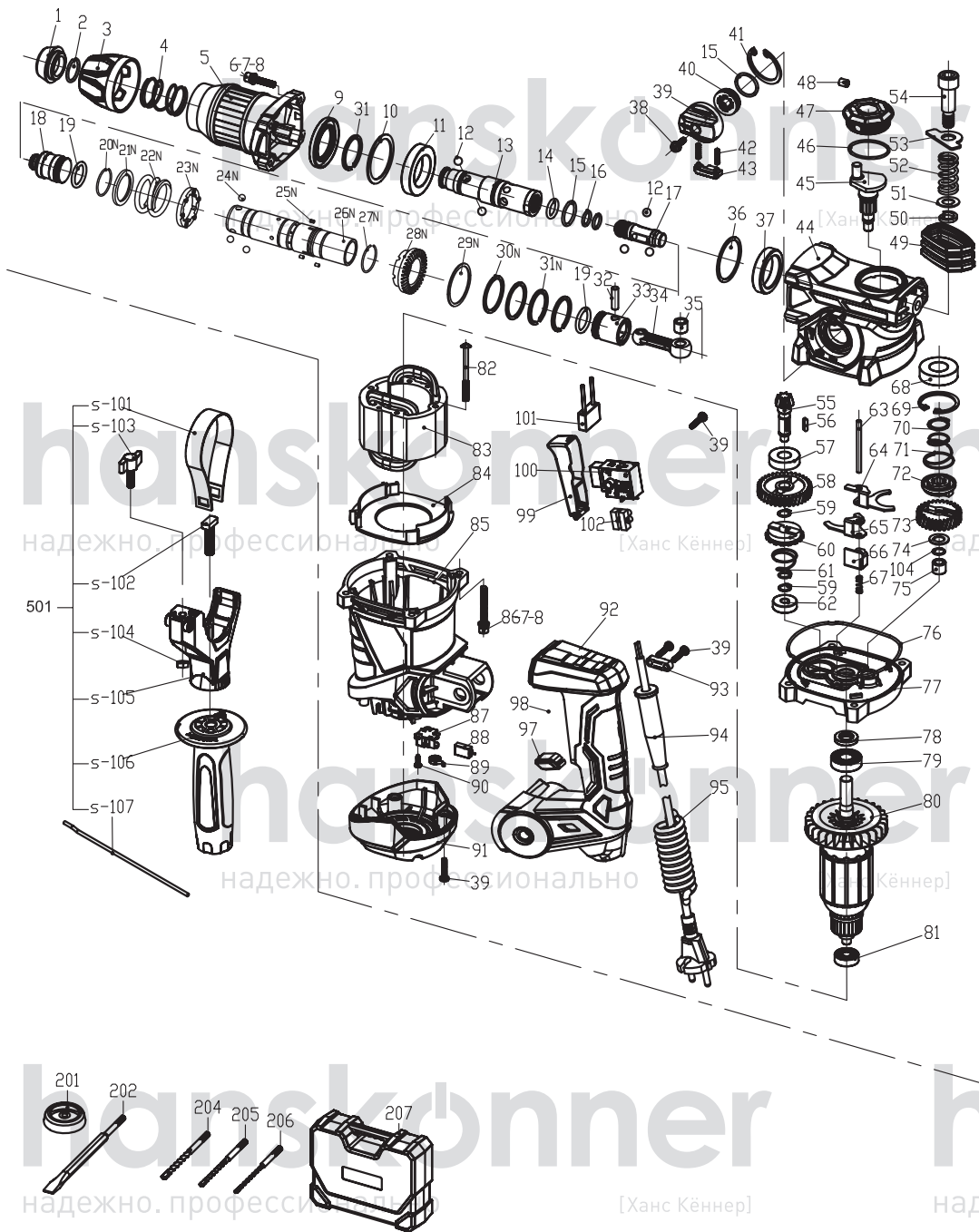

NO.	DESCRIPTION	NO.	DESCRIPTION	NO.	DESCRIPTION
1	FRONT COVER	41	CLIP RING	81	BEARING608
2	CLIP RING	42	BUTTON SPRING	82	SCREW
3	STEEL BALL BLOCK	43	BUTTON	83	STATOR
4	STEEL BALL BLOCK SPRING	44	GEAR BOX	84	AIR DEFLECTOR CIRCLE
5	FRONT PLACKET	45	ECCENTRIC SHAFT	85	HOUSING
6	SCREW	46	O RING	86	SCREW
7	FLAT WASHER	47	OIL COVER	87	CARBON BRUSH
8	SPRING WASHER	48	WOOL FELT	88	BRUSH HOLDER SUPPORT
9	OIL SEALING	49	DAMPING RUBBER SLEEVE	89	SPRING
10	PLATE	50	SPRING WASHER	90	SCREW
11	BEARING61906	51	FLAT WASHER	91	BACK COVER
12	STEEL BALL Ø7.14	52	DAMPING SPRING	92	HANDLE
13	ROTATRY SLEEVE	53	DAMPING PLATE	93	CABLE CLAMP
14	O RING	54	DAMPING SCREW	94	CABLE SHEATH
15	O RING	55	SMALL GEAR	95	VDE PLUG
16	O RING	56	FLAT KEY	97	LIGHT COVER
17	IMPACT HAMMER	57	BEARING6001	98	LIGHT
18	AIR HAMMER	58	SECOND GEAR	99	SWITCH COVER
19	O RING	59	CLIP RING	100	DUSTPROOF SWITCH
20N	CIRCLIP 27X2	60	CLUTCH	101	CAPITANCE
21N	FIXED RING	61	SMALL GEAR SPING	102	BINDING POST
22N	SPRING	62	BEARING627	104	CLIP RING
23N	CLUTCH	63	GUIDE POST	S101	AUXILIARY HANDLE RAND
24N	STEEL BALL 6.35	64	FIRST GEAR WASHER	S102	CLAMPING SCREW
25N	ROLL NEEDLE 3X8	65	SECOND GEAR WASHER	S103	T BOLT
26N	CYLINDER	66	LOCKING PLATE	S104	SCREW M6
27N	CIRCLIP 26.7X1.6	67	LOCKING PLATE SPRING	S105	AUXILIARY HOLDER
28N	CONE GEAR	68	BEARING6003	S106	AUXILIARY HANDLE
29N	WASHER	69	CLIP RING	S107	DEPTH GAUGE
30N	WASHER	70	CLIP RING	201	DUST COVER
31N	LOCKING RING	71	ECCENTRIC SHAFT SPRING	202	FLAT CHISEL
32	PISTON PIN	72	FIRST GEAR CLUTCH	204	DRILL 5MM
33	PISTON	73	FIRST GEAR	205	DRILL 8MM
34	CONNECTING ROD	74	CYLINDER PLATE	206	DRILL 6MM
35	SMALL OIL BEARING	75	NEEDLE BEARING HK0810	207	BLOW CASE
36	WASHER	76	MIDDLE COVER PLATE	501	AUXILIARY HANDLE ACC.
37	OIL BEARING	77	MIDDLE COVER		
38	SCREW ST4	78	ROTOR OIL SEALING		
39	OUTER KNOB	79	BEARING6001		
40	INNER KNOB	80	ROTOR		

HRH1532RE-ex RUS231123